

SW-40 Series

4/10 HP Submersible Sewage Pump, 2" Solids



Features

- Handles liquids and solid waste materials up to 2" diameter.
- Cast iron pump housing and cover with protective epoxy coating for corrosion resistance.
- Oil-filled motor housing for lifetime lubrication and rapid heat dissipation.
- Stainless steel fasteners.
- Mechanical seals (stainless steel spring, nitrile parts, carbon and ceramic faces).
- Thermal overload protection.
- Manual and automatic models.
- Automatic operation has a 9 to 14 inch "ON" level and 2 to 6 inch "OFF" level range with piggyback mechanical float switch.
- Franklin Electric wastewater pumps are rated continuous duty as long as they are run within the published ratings for these pumps.

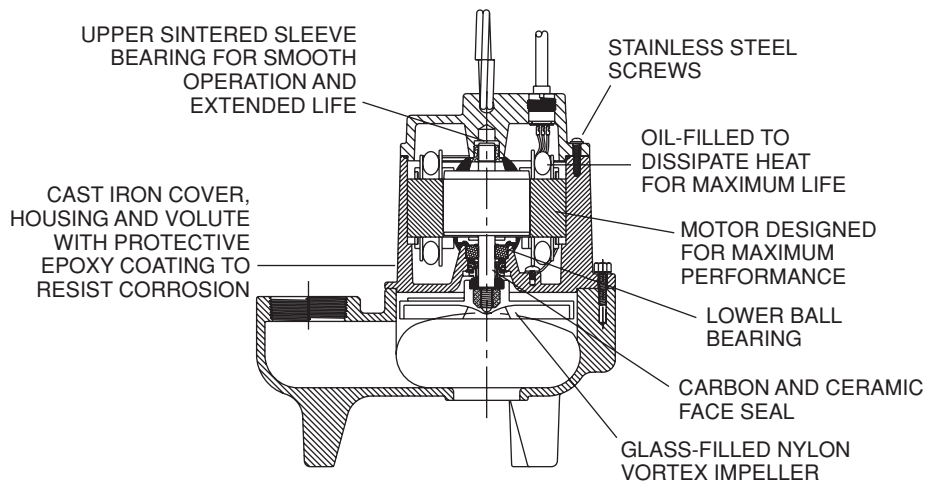

SW-40 Series

4/10 HP Submersible Sewage Pump, 2" Solids

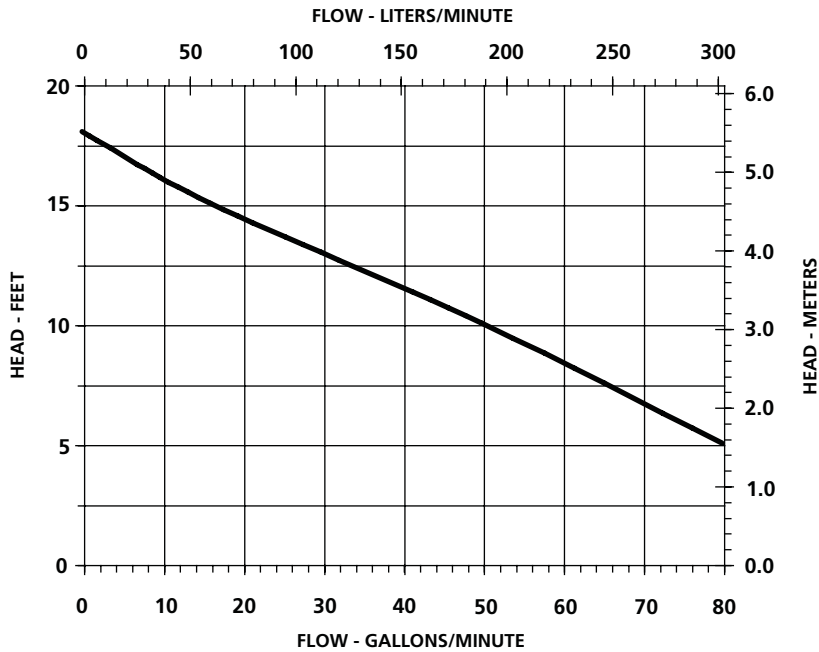

Construction

Cover	Epoxy Coated Cast Iron
Motor Housing	Epoxy Coated Cast Iron
Impeller Material	Nylon
Impeller Type	Vortex
Volute	Epoxy Coated Cast Iron
Power Cord	SJTW
Mechanical Shaft Seal	Nitrile with Carbon and Ceramic Faces
Fasteners	Stainless Steel
Shaft	Steel
Bearings	Upper - Sintered Sleeve Lower - Ball Bearing

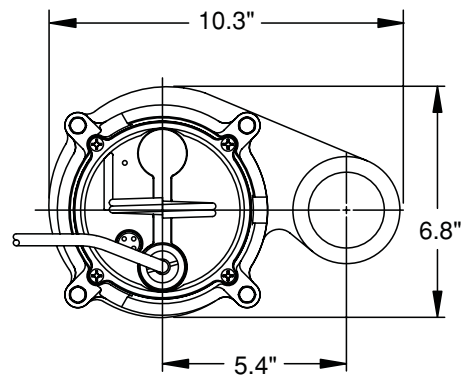
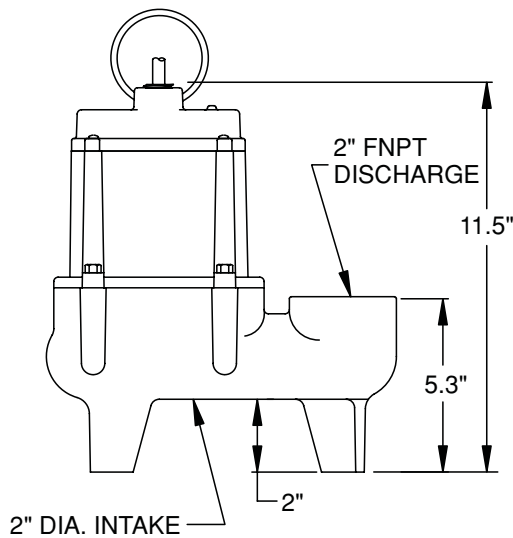

Specifications

MODEL NO.	ITEM NO.	HP	VOLTS	DISCHARGE SIZE	RUNNING AMPS/WATTS	PERFORMANCE (GPM)			SHUT-OFF		CORD LENGTH	WEIGHT (LBS)
						5'	10'	15'	FEET	PSI		
SW-40	509403	4/10	115	2" FNPT	13/1020	80.0	50.0	16.0	18.0	7.8	15'	36.0
	509451	4/10	230	2" FNPT	6.5/1020	80.0	50.0	16.0	18.0	7.8	15**	36.0
SW-40-AF	509501	4/10	115	2" FNPT	13/1020	80.0	50.0	16.0	18.0	7.8	15'	36.0

AF - Piggyback Mechanical Float Switch
* without plug

SWL-40 Series

4/10 HP Submersible Sewage Pump, 2" Solids



SWL-40

SWL-40-AD

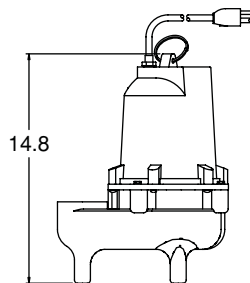
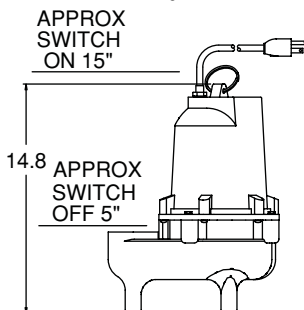
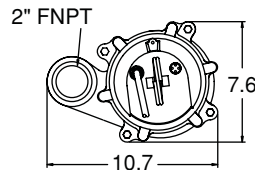
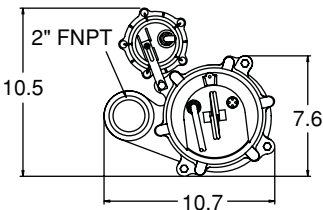

Features

- Powerful, 4/10 HP Permanent Split Capacitor (PSC) motor for high starting and running torque, with low Amp draw to conserve electrical energy.
- Recessed, vortex impeller made of tough, engineered composite material to reduce clogging; will pass 2-inch spherical solids.
- Upper and lower ball bearings for extended motor life.
- Mechanical seal (stainless steel spring, nitrile parts, carbon and ceramic faces) to assure maximum protection against pump failure.
- Rugged cast iron pump housing with epoxy coating for corrosion resistance.
- Diaphragm pressure switch for automatic operation.
- Oil-filled motor housing for lifetime bearing lubrication and maximum heat dissipation.
- Stainless steel hardware to protect against corrosion.
- Thermal overload protection.
- Franklin Electric wastewater pumps are rated continuous duty as long as they are run within the published ratings for these pumps.

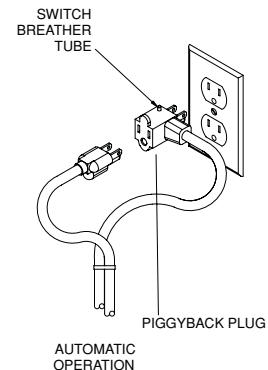

SWL-40 Series

4/10 HP Submersible Sewage Pump, 2" Solids

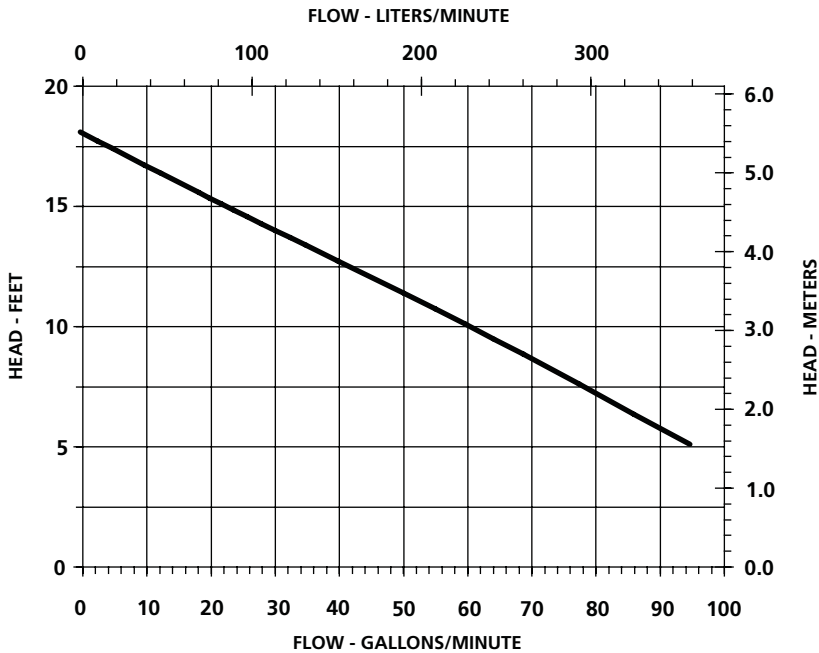

Construction

Motor Housing	Epoxy Coated Cast Iron
Impeller Material	Engineered Composite
Impeller Type	Recessed, Vortex
Volute	Epoxy Coated Cast Iron
Power Cord	16/3 SJTW-A
Mechanical Shaft Seal	Nitrile with Carbon and Ceramic Faces
Fasteners	Stainless Steel
Shaft	Cold Rolled Steel
Bearings	Ball Bearings



Specifications

MODEL NO.	ITEM NO.	HP	VOLTS	DISCHARGE SIZE	RUNNING AMPS/WATTS	PERFORMANCE (GPM)			SHUT-OFF		CORD LENGTH	WEIGHT (LBS)
						5'	10'	15'	FEET	PSI		
SWL-40	509462	4/10	115	2" FNPT	8.9/870	95.0	60.0	22.0	18.0	7.8	20'	52.0
SWL-40-AD	509563	4/10	115	2" FNPT	8.9/870	95.0	60.0	22.0	18.0	7.8	20'	53.0
	509564	4/10	230	2" FNPT	4.5/870	95.0	60.0	22.0	18.0	7.8	20'	55.0

SW-50 Series

1/2 HP Manual Submersible Sewage Pump, 2" Solids



Features

- Handles liquids and solid waste materials up to 2-inch diameter.
- Cast iron pump housing and volute with protective epoxy coating for corrosion and rust resistance.
- Oil-filled motor housing for lifetime lubrication and rapid heat dissipation.
- Stainless steel fasteners.
- Mechanical seals (stainless steel spring, nitrile parts, carbon and ceramic faces).
- Thermal overload protection.
- Franklin Electric wastewater pumps are rated continuous duty as long as they are run within the published ratings for these pumps.

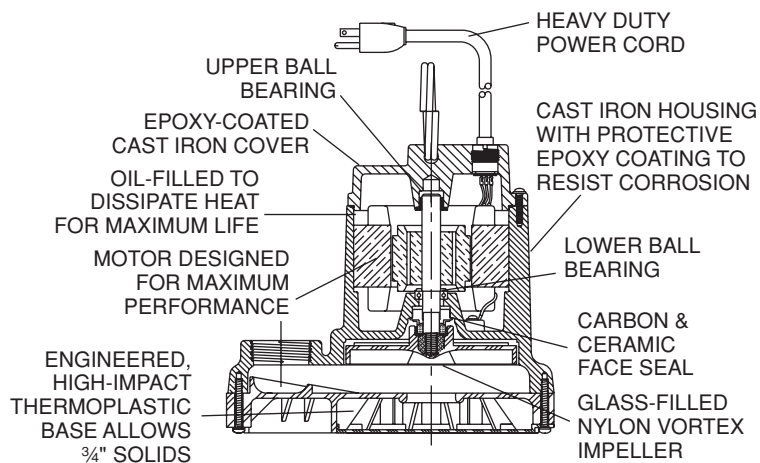

SW-50 Series

1/2 HP Manual Submersible Sewage Pump, 2" Solids

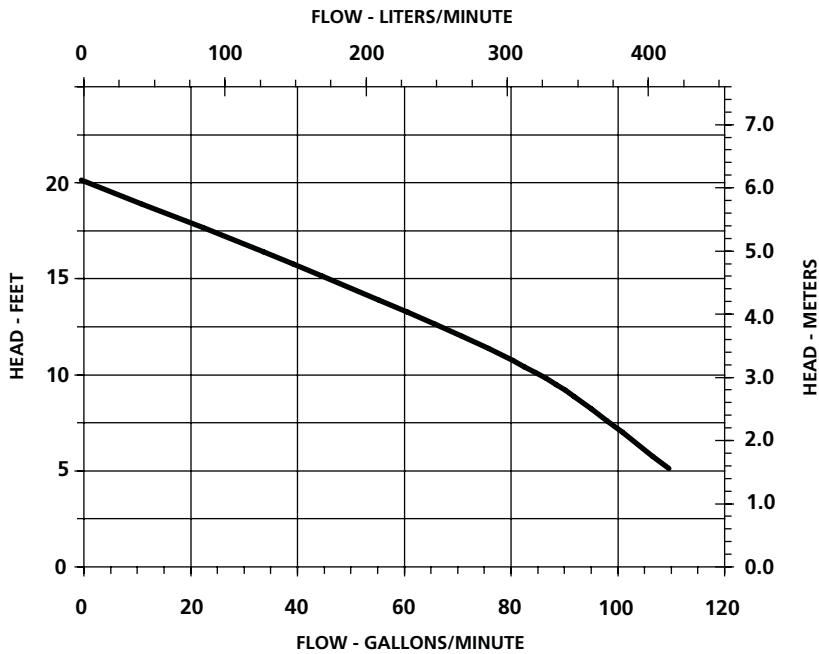

Construction

Motor Housing	Epoxy Coated Cast Iron
Impeller Material	Nylon
Impeller Type	Vortex
Volute	Epoxy Coated Cast Iron
Power Cord	SJTW
Mechanical Shaft Seal	Nitrile with Carbon and Ceramic Faces
Fasteners	Stainless Steel
Shaft	Steel
Bearings	Ball Bearings

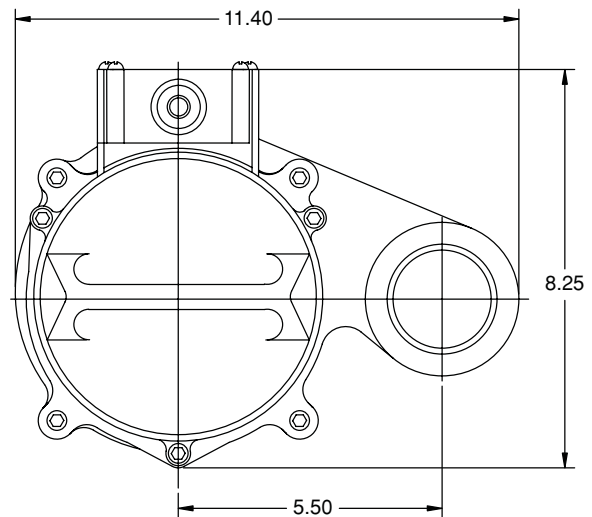
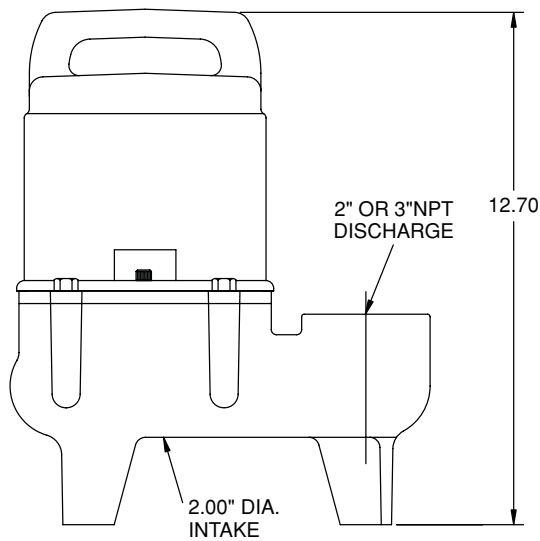

Specifications

MODEL NO.	ITEM NO.	HP	VOLTS	DISCHARGE SIZE	RUNNING AMPS/WATTS	PERFORMANCE (GPM)			SHUT-OFF		CORD LENGTH	WEIGHT (LBS)
						5'	10'	15'	FEET	PSI		
SW-50	511402	1/2	115	2" FNPT	12/1000	110.0	85.0	45.0	20.0	8.7	15'	44.0
	511476	1/2	208/230	2" FNPT	6.6/1100	110.0	85.0	45.0	20.0	8.7	15'	44.0

SW-50-A Series

1/2 HP Automatic Submersible Sewage Pump, 2" Solids

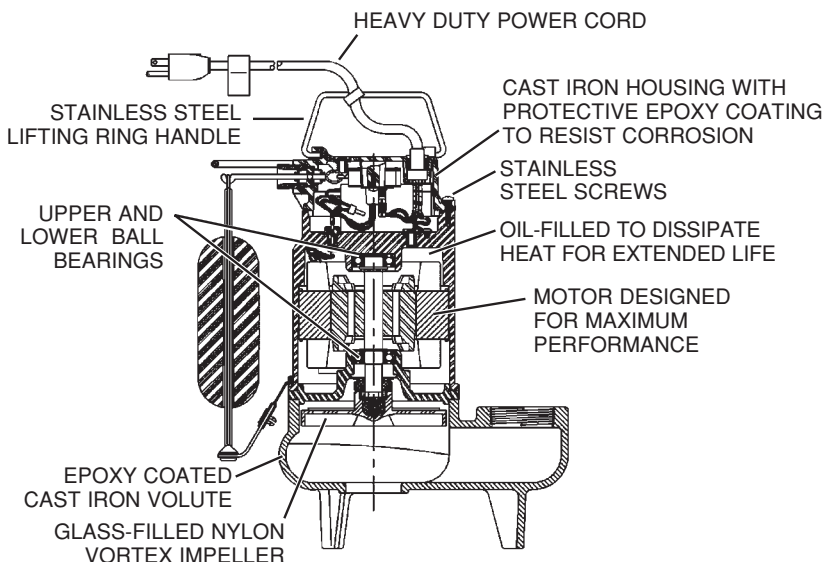

Features

- Handles liquids and solid waste materials up to 2" diameter.
- Cast iron pump housing with protective epoxy coating for corrosion resistance.
- Oil-filled motor housing for lifetime lubrication and rapid heat dissipation.
- Stainless steel screws, bolts, handle and switch guard.
- Mechanical seals (stainless steel spring, nitrile parts, carbon and ceramic faces).
- Thermal overload protection.
- Integral snap-action float switch - Automatic operation has 11 to 14 inch "ON" level range and 5 to 8 inch "OFF" level range.
- Piggyback mechanical float switch - Automatic operation has 15 to 17 inch "ON" level range and 8 to 10 inch "OFF" level range.
- PSC type motor with upper and lower ball bearings.
- Franklin Electric wastewater pumps are rated continuous duty as long as they are run within the published ratings for these pumps.

SW-50-A Series

1/2 HP Automatic Submersible Sewage Pump, 2" Solids

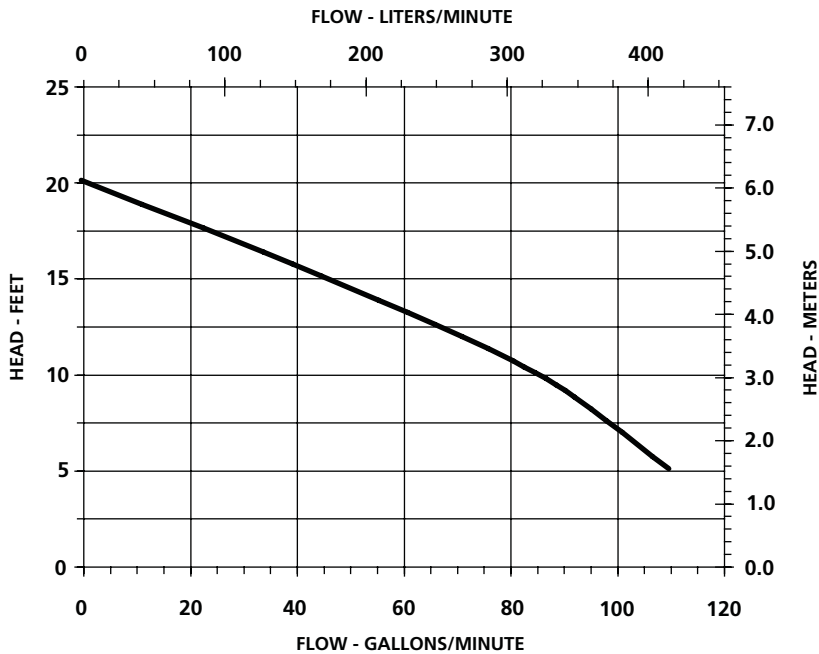

Construction

Motor Housing	Epoxy Coated Cast Iron
Impeller Material	Glass-Filled Nylon
Impeller Type	Vortex
Volute	Epoxy Coated Cast Iron
Power Cord	16-3 SJTW
Mechanical Shaft Seal	Nitrile with Carbon and Ceramic Faces
Fasteners	Stainless Steel
Shaft	Steel
Bearings	Ball Bearings

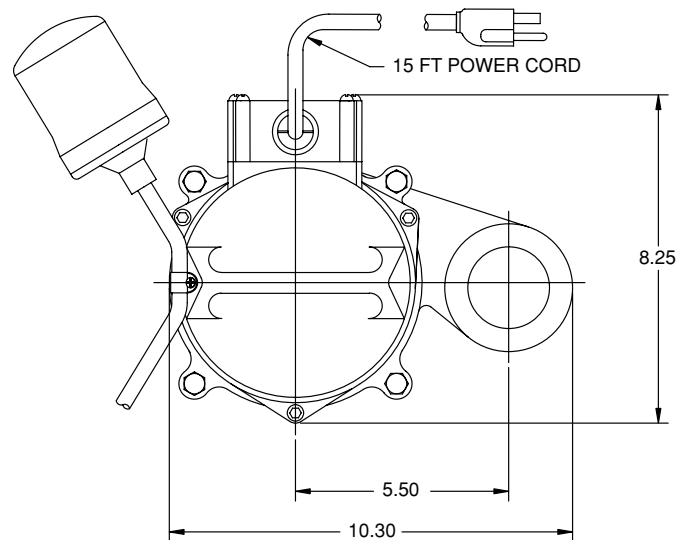
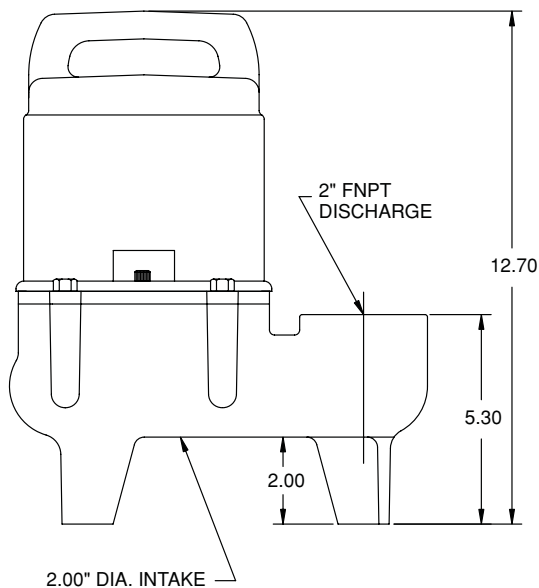

Specifications

MODEL NO.	ITEM NO.	HP	VOLTS	DISCHARGE SIZE	RUNNING AMPS/WATTS	PERFORMANCE (GPM)			SHUT-OFF		CORD LENGTH	WEIGHT (LBS)
						5'	10'	15'	FEET	PSI		
SW-50-AF	511502	1/2	115	2" FNPT	12/1000	110.0	85.0	45.0	20.0	8.7	15'	45.0
SW-50-AS	511551	1/2	115	2" FNPT	9.2/1086	110.0	85.0	45.0	20.0	8.7	10'	46.0
	511566	1/2	230	2" FNPT	4.6/1086	110.0	85.0	45.0	20.0	8.7	25'	47.0

SWL-50-AD Series

1/2 HP Automatic Submersible Sewage Pump, 2" Solids



Features

- Powerful, 1/2 HP Permanent Split Capacitor (PSC) motor for high starting and running torque, with low amp draw to conserve electrical energy.
- Recessed, vortex impeller made of tough, engineered composite material to reduce clogging. Will pass 2" spherical solids.
- Upper and lower ball bearings for extended motor life.
- Mechanical seal (stainless steel spring, nitrile parts, carbon and ceramic faces) to assure maximum protection against pump failure.
- Rugged cast iron pump housing with epoxy coating for corrosion resistance.
- Diaphragm pressure switch for automatic operation.
- Oil-filled motor housing for lifetime bearing lubrication and maximum heat dissipation.
- Stainless steel hardware to protect against corrosion.
- Thermal overload protection.
- Franklin Electric wastewater pumps are rated continuous duty as long as they are run within the published ratings for these pumps.

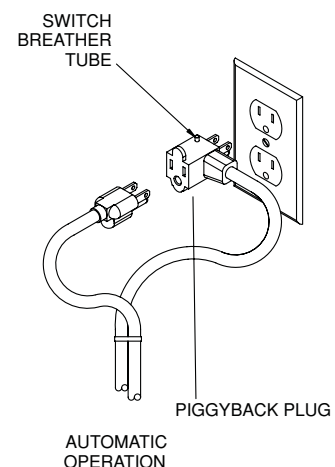

SWL-50-AD Series

1/2 HP Automatic Submersible Sewage Pump, 2" Solids

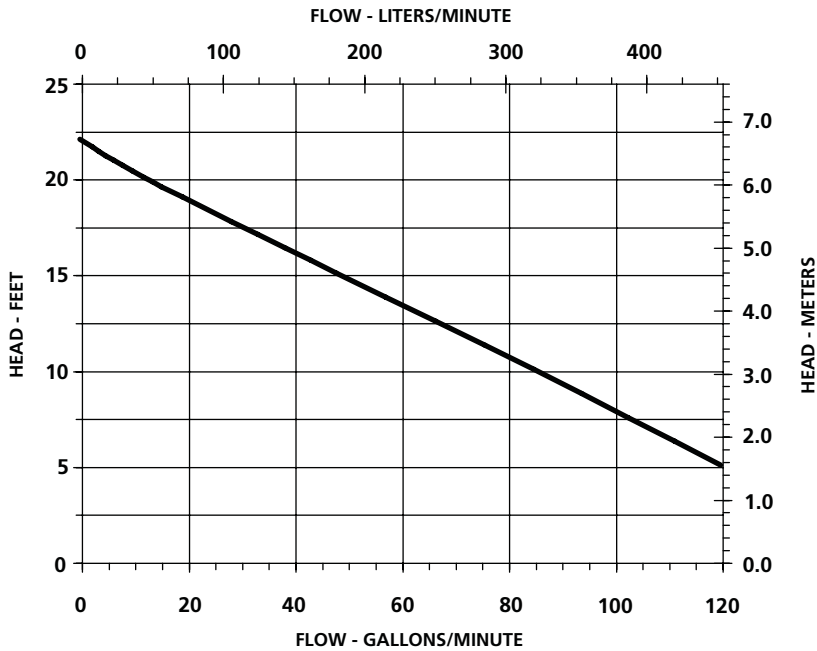

Construction

Motor Housing	Epoxy Coated Cast Iron
Impeller Material	Engineered Composite
Impeller Type	Recessed, vortex
Volute	Epoxy Coated Cast Iron
Power Cord	16/3 SJTW-A
Mechanical Shaft Seal	Nitrile with Carbon and Ceramic Faces
Fasteners	Stainless Steel
Shaft	Cold Rolled Steel
Bearings	Ball Bearings

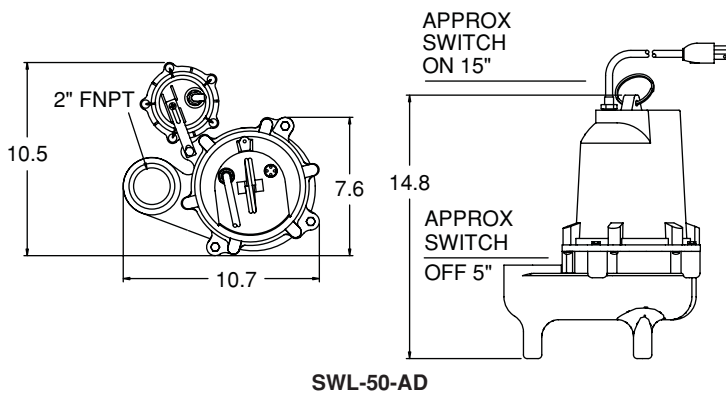

SWL-50-AD

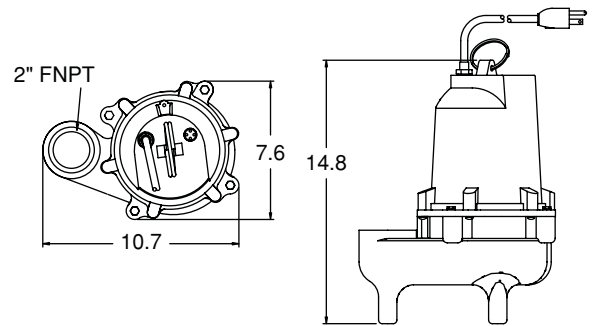

SWL-50

Specifications

MODEL NO.	ITEM NO.	HP	VOLTS	DISCHARGE SIZE	RUNNING AMPS/WATTS	PERFORMANCE (GPM)			SHUT-OFF		CORD LENGTH	WEIGHT (LBS)
						5'	10'	15'	FEET	PSI		
SWL-50	511502	1/2	115	2" FNPT	12/1000	120.0	85.0	48.0	12.0	22.0	10'	53.0
SWL-50-AD	511551	1/2	115	2" FNPT	9.2/1086	120.0	85.0	48.0	12.0	22.0	10'	54.0
	511566	1/2	230	2" FNPT	4.6/1086	120.0	85.0	48.0	12.0	22.0	20'	54.0

SW-50H Series

1/2 HP Manual Submersible Sewage Pump, 2" Solids



115 V Models Only

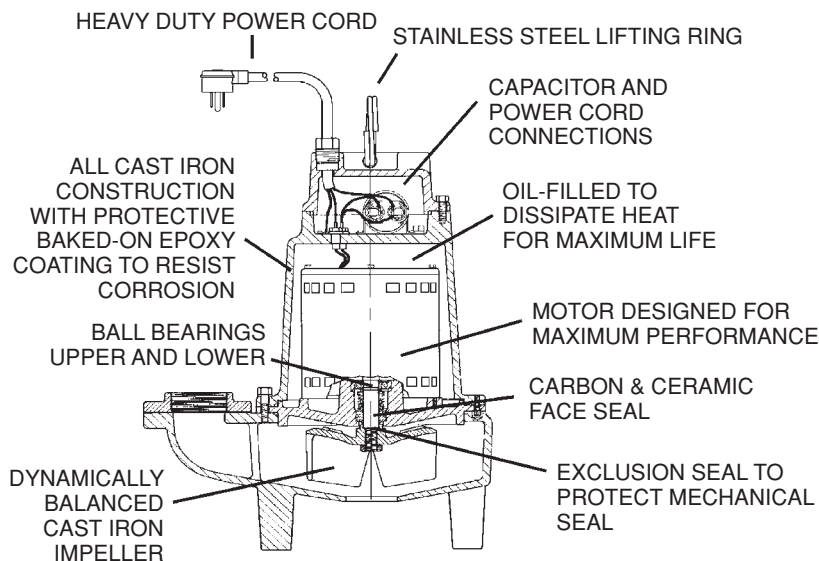

Features

- Handles liquids and solid waste materials up to 2-inch diameter.
- Cast iron pump housing with protective epoxy coating for corrosion resistance.
- Oil-filled motor housing for lifetime lubrication and rapid heat dissipation.
- Stainless steel screws, bolts and lifting ring.
- Mechanical seal (stainless steel spring, nitrile parts, carbon and ceramic faces) for long life and reliability.
- Secondary exclusion seal to help protect mechanical seal.
- ½ hp, 1625 RPM, ball bearing motor and thermal overload protection.
- Capacitor and power cord connections isolated from oil -filled motor housing for ease of field maintenance.
- Dynamically balanced two-vane non-clogging impeller with pump-out vanes to enhance pumping performance and efficiency.
- Franklin Electric wastewater pumps are rated continuous duty as long as they are run within the published ratings for these pumps.

SW-50H Series

1/2 HP Manual Submersible Sewage Pump, 2" Solids

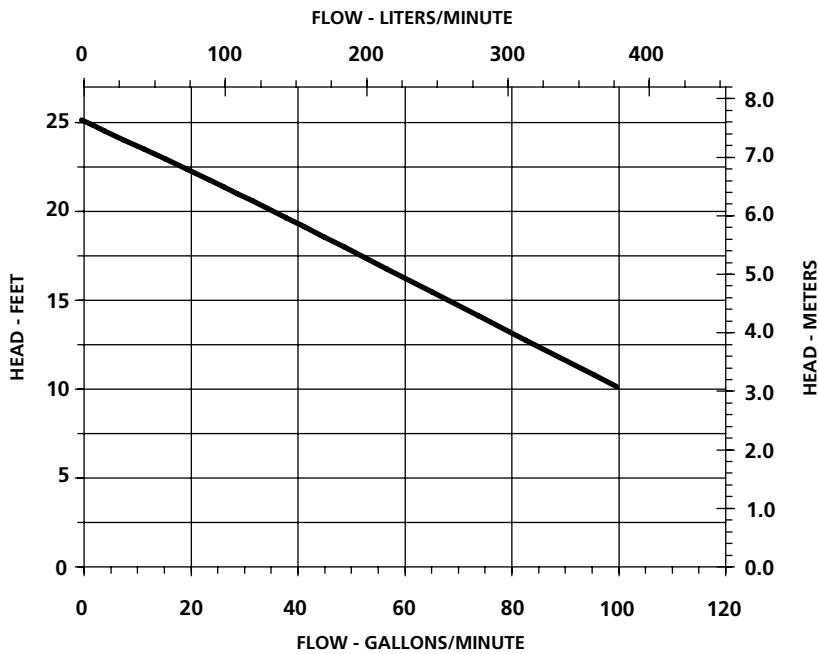

Construction

Motor Housing	Epoxy Coated Cast Iron
Impeller Material	Epoxy Coated Cast Iron
Impeller Type	Two Vane, Non-Clog
Volute	Epoxy Coated Cast Iron
Power Cord	16/3, STW
Mechanical Shaft Seal	Nitrile with Carbon and Ceramic Faces
Fasteners	Stainless Steel
Shaft	Stainless Steel
Bearings	Ball Bearings

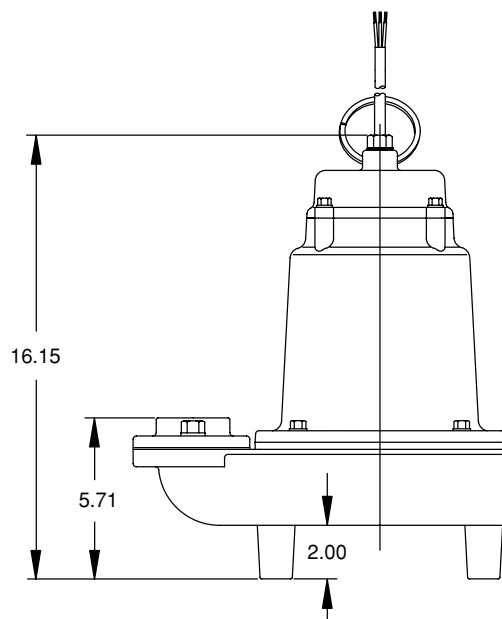
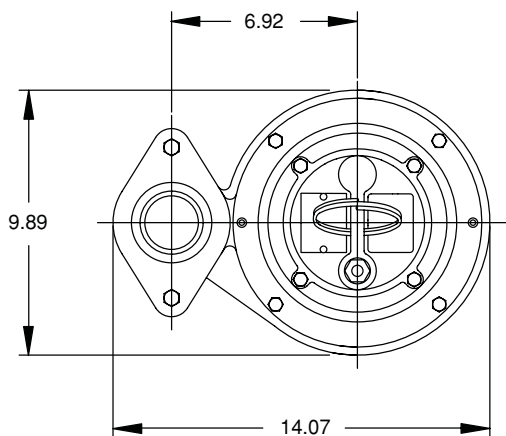

Specifications

MODEL NO.	ITEM NO.	HP	VOLTS	DISCHARGE SIZE	RUNNING AMPS/WATTS	PERFORMANCE (GPM)		SHUT-OFF		CORD LENGTH	WEIGHT (LBS)
						10'	20'	FEET	PSI		
SW-50H	514322	1/2	115	2"	11.6/1100	100.0	35.0	25.0	10.8	20'	87.0
	514323	1/2	208-240	2"	4.6/1100	100.0	35.0	25.0	10.8	20'	88.0

SW-100 Series**1 HP Manual Submersible Sewage Pump, 2" Solids**

575 volt model is CSA only

Features

- Handles liquids and solid waste materials up to 2" diameter.
- Cast iron pump housing with protective epoxy coating for corrosion resistance.
- Oil-filled motor housing for lifetime lubrication and rapid heat dissipation.
- Stainless steel screws, bolts and lifting ring.
- Mechanical seals (stainless steel spring, nitrile parts, carbon and ceramic faces) for long life and reliability.
- Secondary exclusion seal to help protect mechanical seal.
- 1 hp ball bearing motor.
- Thermal overload protection.
- Permanent split capacitor design on single-phase models.
- Capacitor and power cord isolated from oil-filled motor housing for ease of field maintenance.
- Dynamically balanced two-vane non-clogging impeller with pump-out vanes to protect seal
- Franklin Electric wastewater pumps are rated continuous duty as long as they are run within the published ratings for these pumps.

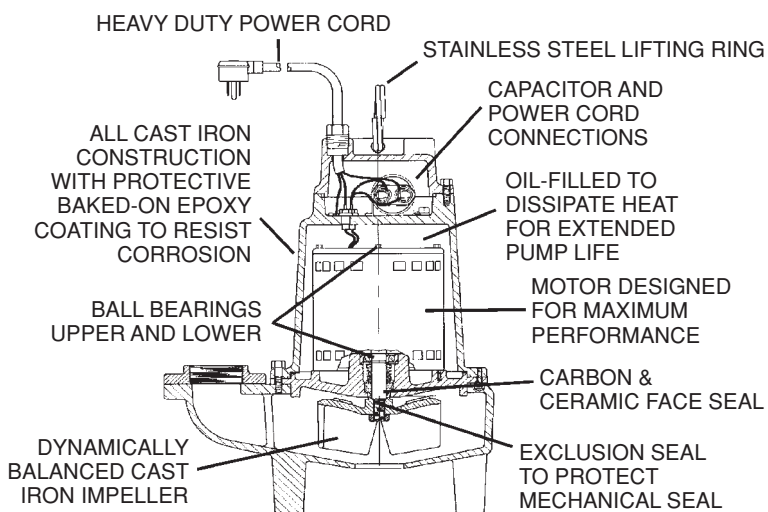

SW-100 Series

1 HP Manual Submersible Sewage Pump, 2" Solids

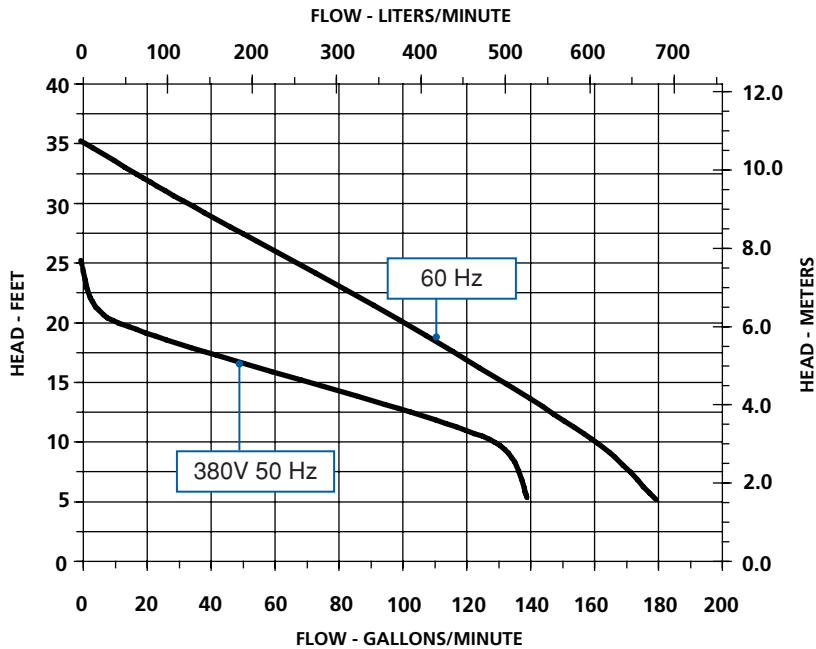

Construction

Motor Housing	Epoxy Coated Cast Iron
Impeller Material	Epoxy Coated Cast Iron
Impeller Type	Two Vane, Non-Clog
Volute	Epoxy Coated Cast Iron
Power Cord	16/3, STW
Mechanical Shaft Seal	Nitrile with Carbon and Ceramic Faces
Fasteners	Stainless Steel
Shaft	Stainless Steel
Bearings	Ball Bearings

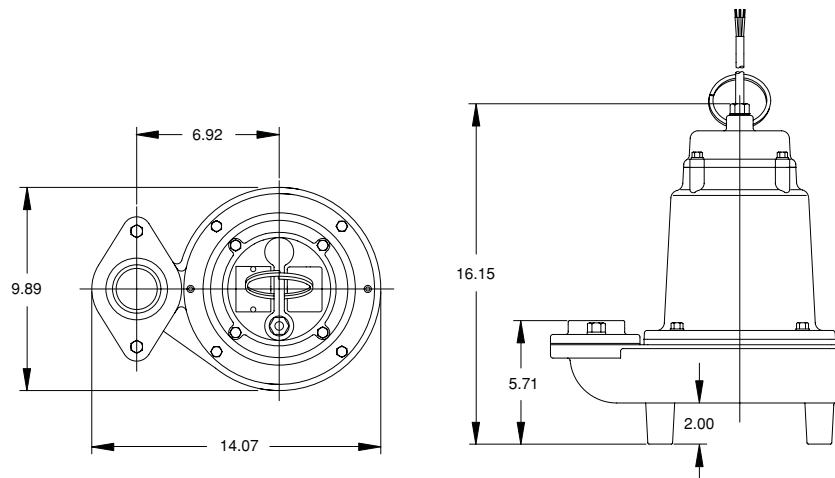

Specifications

MODEL NO.	ITEM NO.	HP	VOLTS	PHASE	DISCHARGE SIZE	RUNNING AMPS/WATTS	PERFORMANCE (GPM)				SHUT-OFF		CORD LENGTH**	WEIGHT (LBS)
							5'	10'	20'	30'	FEET	PSI		
SW-100	514621	1	230	1	3"	11.0/1900	180	160	100	32	35.0	15.1	20'	88.0
	514626	1	200-208	1	3"	11.0/2000	180	160	100	32	35.0	15.1	20'	88.0
	514721	1	230	3*	3"	6.3/1550	180	160	100	32	35.0	15.1	20'	88.0
	514731	1	460/380	3*	3"	3.2/1400	180	160	100	32	35.0	15.1	20'	88.0
	514741	1	575	3*	3"	2.5/1400	180	160	100	32	35.0	15.1	20'	88.0
	514751	1	200-208	3*	3"	6.8/1400	180	160	100	32	35.0	15.1	20'	88.0

*3-phase pumps require control panel to operate
 **Without plug

SW-150 Series

1.5 HP Manual Submersible Sewage Pump, 2" Solids



Features

- Handles liquids and solid waste materials up to 2" diameter.
- Cast iron pump housing with protective epoxy coating for corrosion resistance.
- Oil-filled motor housing for lifetime lubrication and rapid heat dissipation.
- Stainless steel hardware.
- Mechanical seal (stainless steel spring, nitrile parts, carbon and ceramic faces) for long life and reliability.
- 1.5 hp ball bearing motor.
- Exclusion seal.
- Thermal overload protection on single phase units.
- Capacitor and power cord isolated from oil-filled motor housing for ease of field maintenance.
- Brass impeller.
- Franklin Electric wastewater pumps are rated continuous duty as long as they are run within the published ratings for these pumps.

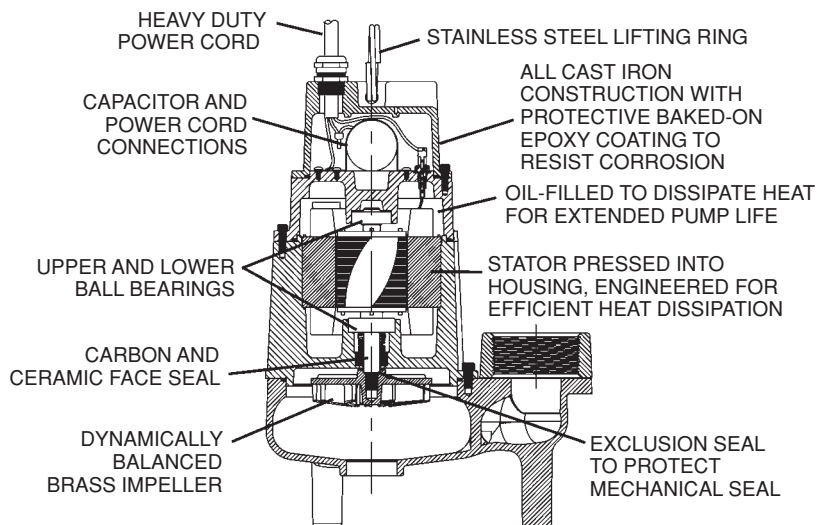

SW-150 Series

1.5 HP Manual Submersible Sewage Pump, 2" Solids

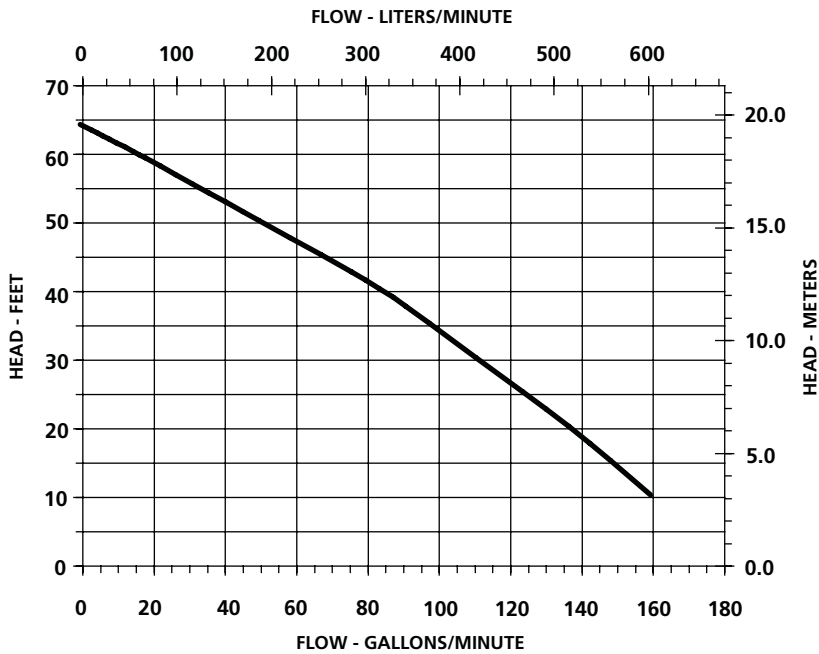

Construction

Cover	Epoxy Coated Cast Iron
Motor Housing	Epoxy Coated Cast Iron
Impeller Material	Red Brass
Impeller Type	Non-Clog
Volute	Epoxy Coated Cast Iron
Power Cord	14/3, SOW (1-Phase), 14/4, SOW (3-Phase)
Mechanical Shaft Seal	Carbon/Ceramic
Fasteners	Stainless Steel
Shaft	Stainless Steel
Bearings	Ball Bearings

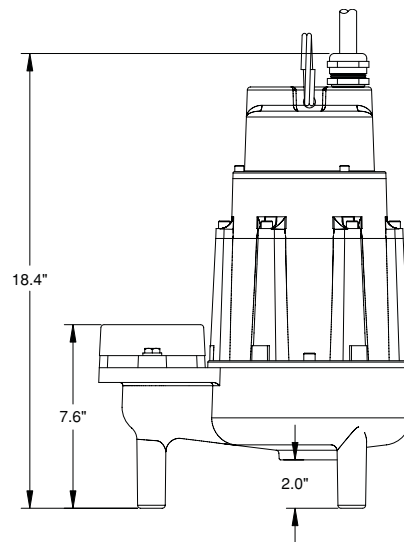
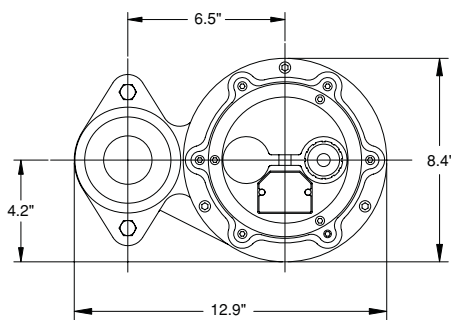

Specifications

MODEL NO.	ITEM NO.	HP	VOLTS	PHASE	DISCHARGE SIZE	RUNNING AMPS/WATTS	PERFORMANCE (GPH)						SHUT-OFF		CORD LENGTH	WEIGHT (LBS)
							10'	20'	30'	40'	50'	60'	FEET	PSI		
SW-150	520305	1.5	208	1	3"	16.0/3229	160.0	137.0	111.0	84.0	50.0	15.0	64.0	27.7	20'	96.0
	520306	1.5	230	1	3"	15.5/3512	160.0	137.0	111.0	84.0	50.0	15.0	64.0	27.7	20'	96.0
	520307	1.5	200-208	3*	3"	13.5/1644	160.0	137.0	111.0	84.0	50.0	15.0	64.0	27.7	20'	96.0
	520308	1.5	230	3*	3"	11.5/1512	160.0	137.0	111.0	84.0	50.0	15.0	64.0	27.7	20'	96.0
	520309	1.5	460	3*	3"	5.3/1474	160.0	137.0	111.0	84.0	50.0	15.0	64.0	27.7	20'	96.0

*3-phase pumps require control panel

SW-200 Series

2 HP Manual Submersible Sewage Pump, 2" Solids



Features

- Handles liquids and solid waste materials up to 2-inch diameter.
- Cast iron pump housing with protective epoxy coating for corrosion resistance.
- Oil-filled motor housing for lifetime lubrication and rapid heat dissipation.
- Stainless steel screws, bolts and seal assembly.
- Mechanical seal (stainless steel spring, nitrile parts, carbon and ceramic faces) for long life and reliability.
- 2 hp ball bearing motor.
- Exclusion seal.
- Thermal overload protection on single phase units.
- Capacitor and power cord isolated from oil-filled motor housing for ease of field maintenance.
- Brass impeller.
- Franklin Electric wastewater pumps are rated continuous duty as long as they are run within the published ratings for these pumps.

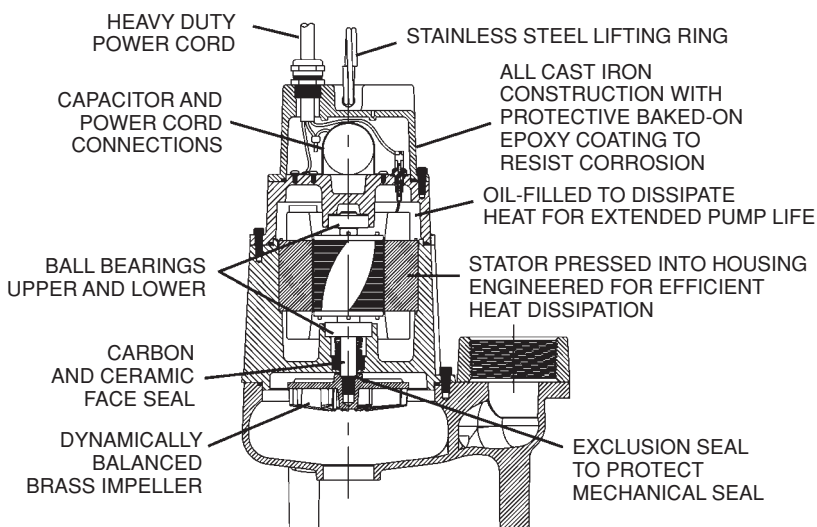

SW-200 Series

2 HP Manual Submersible Sewage Pump, 2" Solids

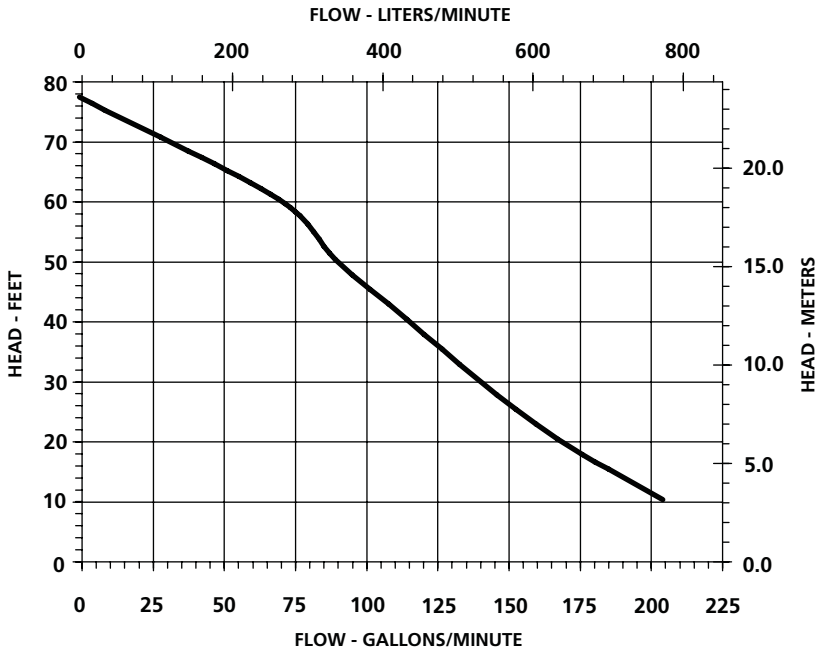

Construction

Cover	Epoxy Coated Cast Iron
Motor Housing	Epoxy Coated Cast Iron
Impeller Material	Red Brass
Impeller Type	Non-Clog
Volute	Epoxy Coated Cast Iron
Power Cord	14/3, SOW
Mechanical Shaft Seal	Carbon/Ceramic
Fasteners	Stainless Steel
Shaft	Stainless Steel
Bearings	Ball Bearings

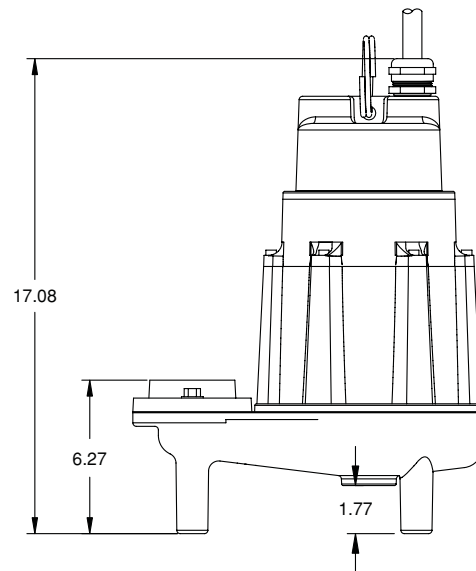
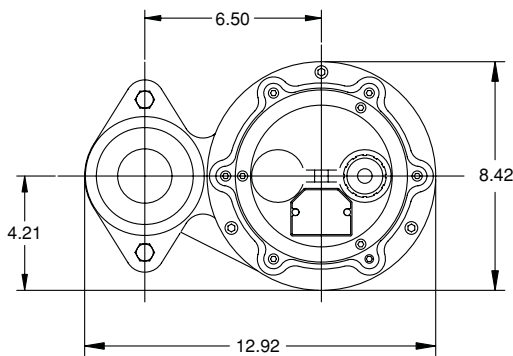

Specifications

MODEL NO.	ITEM NO.	HP	VOLTS	PHASE	DISCHARGE SIZE	RUNNING AMPS/WATTS	PERFORMANCE (GPH)						SHUT-OFF		CORD LENGTH	WEIGHT (LBS)
							10'	20'	30'	40'	50'	60'	FEET	PSI		
SW-200	520101	2	208/230	1	3"	18.0/4118	205.0	168.0	140.0	115.0	90.0	70.0	77.0	33.3	20'	96.0
	520126	2	200-208	3*	3"	14.5/2769	205.0	168.0	140.0	115.0	90.0	70.0	77.0	33.3	20'	96.0
	520151	2	230	3*	3"	12.6/2686	205.0	168.0	140.0	115.0	90.0	70.0	77.0	33.3	20'	96.0
	520176	2	460	3*	3"	6.1/2771	205.0	168.0	140.0	115.0	90.0	70.0	77.0	33.3	20'	96.0

*3-phase pumps require control panel

SWG-200 Series

2 HP Manual Submersible Grinder Pump



Features

- Compact and light package, only 75 lbs.
- Non-overloading design.
- Externally mounted start components.
- Mechanical seal: carbon/ceramic.
- Deflection resistant, short motor shaft.
- Corrosion resistant brass impeller minimizes downtime and maintenance.
- Seven-vane, angled face, non-clogging, balanced impeller.
- Tight cutting clearances for better cutting action.
- Epoxy coated finish for corrosion resistance and durability.
- Built-in overload protection prevents over-current and over-temperature damage.

GP-CK Grinder Capacitor Kit

- To be used to operate SWG-200.
- Includes:
 - Start capacitor.
 - Run capacitor.
 - Relay.
 - End caps.
 - Mounting hardware.

SWG-200 Series 2 HP Manual Submersible Grinder Pump

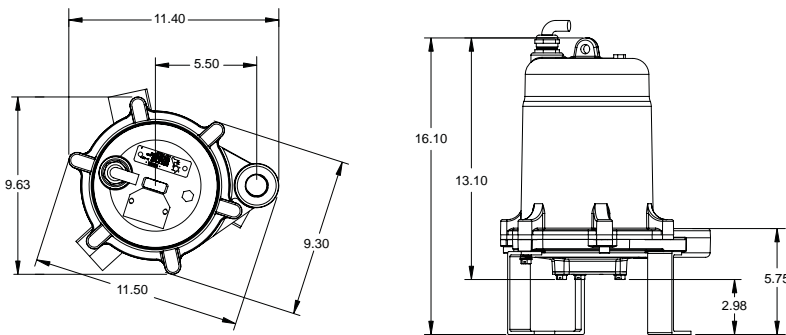
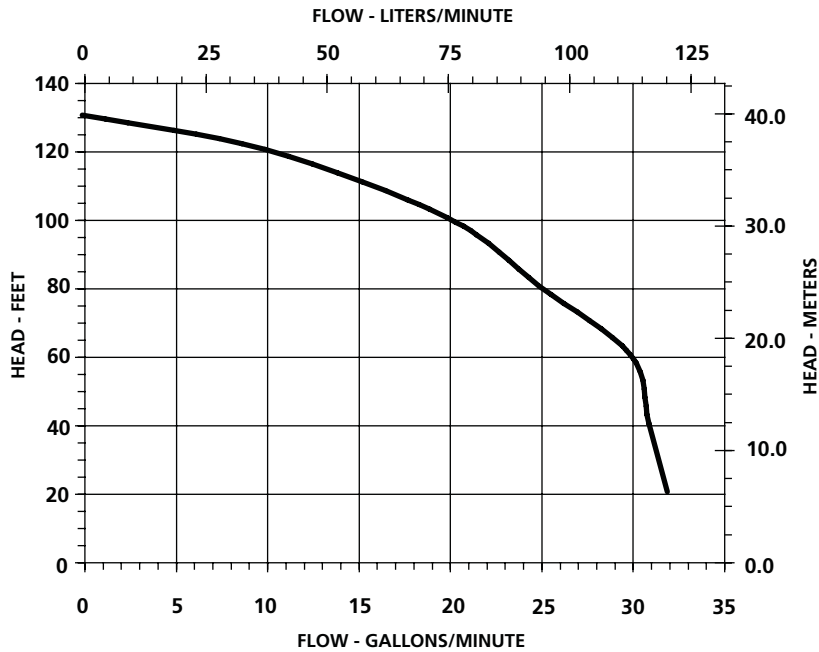

Shown with Stainless Steel GLK Series Grinder Leg Kit. See dealer for details.

Construction

Motor Cover	Epoxy Coated Cast Iron
Motor Cover O-ring	Nitrile
Motor Design	Single-Phase, Capacitor Start, Capacitor Run
Insulation Class	F
Overload Protection	Internal, On Winding Thermal Protector
Motor Shaft	AISI 300 Series Stainless Steel
Upper Ball Bearing	Single Row Ball, 6203
Lower Ball Bearing	Single Row Ball, 6306
Seal Housing	Epoxy Coated Cast Iron
Mechanical Seal	Carbon/Ceramic
Volute	Epoxy Coated Cast Iron
Impeller	Brass
Rotating Cutter	Two Blade Design, AISI 440C Stainless Steel, Through Hardened to Rockwell 55-60C
Stationary Cutter	AISI 440C Stainless Steel, Through Hardened to Rockwell 55-60 °C
External Hardware	300 Series Stainless Steel
Power Cable	Type SOOW or SOW 14/4 AWG

Specifications

MODEL NO.	ITEM NO.	HP	VOLTS	DISCHARGE SIZE	RUNNING AMPS/WATTS	PERFORMANCE (GPH)						SHUT-OFF		CORD LENGTH	WEIGHT (LBS)
						20'	40'	60'	80'	100'	120'	FEET	PSI		
SWG-200	520854	2	208	1.25" FNPT	13.9/3200	32.0	31.0	30.0	25.0	20.0	10.0	130.0	65.0	15'	75.0
	520866	2	230	1.25" FNPT	13.9/2000	32.0	31.0	30.0	25.0	20.0	10.0	130.0	65.0	15'	75.0
SWG-200-AF	520876	2	230	1.25" FNPT	13.9/2000	32.0	31.0	30.0	25.0	20.0	10.0	130.0	65.0	20'	75.0